

1820-042  
Loudon Co.

CHANCERY CAUSES: JAMES GRADEY VS. JOHN ROMINE'S  
HEIRS

M1476

2 plats

Rebecca Romine, widow

Susannah, Ann, Elizabeth, John, Rachel & Isaiah Romine

Mary & W<sup>m</sup> Francis

Sarah & Jeremiah McVeigh

deposition- Elijah Marks

Jonathan Waters

Lydia Reed

Jonathan Drake

To the Worshippfull Court of Loudoun County sitting in Chancery

Humbly Complaining your Orator James Grady sheweth  
unto your Waships. That your Orator is the owner of a tract  
or parcel of land situated in the County of Loudoun adjacent to  
a piece of land late the property of John Romine decd. - That  
the lines between the said John Romine and your Orator were

established in the life time of the said John, and your Orator  
always contended, and believeth that the said John claimed  
possessed more land than he was intitled<sup>to</sup>, and land which in  
fact belongs to your Orator, and your Orator was anxious in  
the life time of the said John to have a just and amicable  
settlement of the said lines, but it so happened that the said  
John departed this life without having made the said settlement  
or any arrangement whatever respecting the same - Your

Orator saith that the said John left a widow, to wit Rebecca  
Romine whom your Orator prayeth may be made a defendant  
to this Bill of Complaint, and the following children to wit; Susannah  
Ann, Elizabeth, John, Rachael, and Isaiah, as also Mary who intemarried  
with William Francis, and Sarah who intemarried with  
Jeremiah McVeigh, all of whom your Orator prayeth may be made  
defendants to this Bill of Complaint. Your Orator saith that after

the death of the said John the aforesaid defendants divided his lands among <sup>them</sup> according to their respective interests therein, as will more fully appear by the records of this Worshippfull Court, and to which ~~think~~ your Orator begs leave to refer. Your Orator saith that in the division aforesaid, the said defendants claimed and allotted to themselves lands which belong as your Orator conceives to himself and which for that reason should not have been divided among the said defendants. And the said allotment and division ~~has~~ been made as aforesaid your Orator hath no hope of an ~~amendment~~ settlement of the aforesaid boundaries, and in truth the said defendants have altogether refused to establish the said boundaries pretending that the lands divided among <sup>them</sup> as aforesaid appertain and belonged to the Estate of the said John Romine dec<sup>d</sup> and not to your Orator - Your Orator here begs leave to refer your Worshipp so to a plat made in this suit, of the contested lines between the representations of the said John Romine and your Orator - your Orator saith that the lines of the said John Romines Deed are truly described upon the said plat by the black lines and Letters A. B. and C. and the representations of the said John, to wit the aforesaid defendants, are not intitled to any land by virtue of the aforesaid Deed of the said John Romine dec<sup>d</sup> beyond the said lines - and your

Orator trusts he shall be able to prove the same to the satisfaction of your Worship - The defendants contend that the red line and corner at red B. is the proper line <sup>corner</sup> of the said Mo. Romines Deed, and they have divided the land of the said Mo. Romine and up to the said red line and claim the same as their right and property all which actings and doings of the said defendants are contrary to equity and good conscience and tend to the manifest wrong and oppression of your Orator - In tender consideration whereof and inasmuch as your Orator is remediless in the premises by the strict rules of the Common Law and cannot settle and ~~cannot settle~~ establish the boundary line aforesaid between the said defendants and himself <sup>or perpetuate the evidence respecting the same</sup> without the assistance of this Worshippfull Court where matters of this nature are properly cognizable - To the End therefore that the said defendants may true and proper answer make to all and singular the premises as fully and particularly as if the same were herein again repeated and interrogated - And that this said Worshippfull Court may establish the boundary lines between the said defendants and your Orator, and perpetuate your Orators Testimony concerning the same, and that this Worshippfull Court may make such other awards and decree in the premises as to them shall seem consistent with equity and good conscience may it please your Worshipp to grant to your Orator the commonwealths most Gracious will of Sup<sup>o</sup> &c.

Sworn for the Complainant

Grady

as<sup>c</sup>

rice

Rominus Heis  
1803 ans<sup>c</sup> PLS  
1803 September filed  
Case set for decree

1806 April 10<sup>th</sup> Decree  
No 10 (see ultimate book)

1812 July 15<sup>th</sup> Cont<sup>d</sup>

May 13. Answer filed Interlocu-  
tory decree decree set aside  
& On motion Decree of Dist

Order Survey

1820 July 16<sup>th</sup> Abates Cont<sup>d</sup>  
Dead

The answer of Rebecca Nomine widow and Relict of John  
Romine dec'd. To a Bill in Chancery exhibited against her and  
the Representatives of John Romine dec'd. in the County Court  
of Loudoun.

This Respondent saving and reserving to herself  
all and every benefit of exception to the many uncertainties  
untroths & imperfections in the Comptys Bill contained for full  
complete and perfect answer thereto or to so much thereof as she is  
advised that it is material for her to make answer unto  
she answering saith: That she admits the division of John Romines  
land amongst his Representatives but cannot believe that any of  
the Land belonging to the Complainant was included in the  
survey made for them on the division - This Respondent  
many years ago assisted in carrying a Chain-iron Survey made  
by William Dillon of the line from black A to black B  
or from the corner of John Hanbys Patent John Romines, Levin  
Dowells & the Complainants on the course towards B - and they  
measured the length of Chain & found no corner - They there  
made a mark about the place described by black B  
where the stone stood <sup>on the survey in this cause</sup> and Dillon complained of  
indisposition & said as it was late he would make  
a mark where the Chain ended & ~~since a good~~  
~~on~~ return home - and told her Husband that where  
ever the line from the white <sup>oak</sup> at C as described on  
the plat - intersected the line from A Hanbys to corner  
there the corner would be made - This Respondent  
heard William Dillon tell John Romine to make some  
mark where the chain ended or run out - that he  
might find the intersection and make a corner - but  
what kind of mark, by stone or other wise was  
made she knows not as she left them at the place  
where the number of Chain ended & near or somewhere  
about the place where the stone stood at the <sup>time of</sup> survey  
made in this cause.

This Respondent knows nothing of John Rommie  
Corner - further than she has above related all  
her information about the line arose from the  
survey made by Dillon & her Husband - ~~neither~~<sup>with</sup>  
of whom ~~she~~ she believes to have been ignorant  
of ~~the~~ any corner being about the place  
where the chain ended which was in the woods  
where trees in abundance could have been found  
for the purpose of making a Corner had one been  
designed to have been made there - and Dillon's  
declaration that the intersection of the two lines  
above spoken of would show the place where  
the corner ought to be, plainly proves that they  
knew it ought not to have been at the place where  
the little stone mention'd in the survey was found -

This Respondent denies all combination fraud &c and  
prays to be hence dismissed with her costs in this behalf  
wrongfully expended - Rebecca ~~her~~ Rommie  
1809 May 11<sup>th</sup> do onto  
in test Isaac Larow Clerk

X

Domine

ads } ans?

Grady to

1809 May 13<sup>th</sup> filed

The answer of Susanna, Ann Elizabeth, & John  
Romine. Infants of John Romine dec. under the age  
of twenty one years by William Francis their  
Guardian assigned, & next friend: to a suit debi-  
-tured in the County Court of London, against  
Rebecca Romine Widow &c. of John Romine  
dec. and others in Chy by James Gadey  
These respondents saving and reserving to themselves all  
and every benefit of exception to the many incertai-  
-nties contained in the Comptts. Bill contained for  
answer thereto. say that they know nothing of the  
Matters set forth and contained in the Dfts. Bill -  
They neither can deny the facts set forth, nor  
can they admit the ~~same~~ statements made by the  
Comptts. to be true, As Infants under the age  
of twenty years they by their Guardian, & next  
Friend, trust totally to the discretion of  
this Hon<sup>ble</sup>. Court, confiding in their judgment  
for the rendition of such decree as may  
comport with equity and good conscience.

They deny all combination &c. & pray to be dismissed  
hence with their costs in this behalf wrongfully  
expended.

John Romine  
Susanna Romine  
Ann Romine  
Elizabeth Romine  
By William Francis  
their Guardian and  
next friend



The ~~Deposits~~ Answer of William Francis to  
a Bill in Chancery exhibited ag. Rebecca Romine  
Widow & Depts in Chy by James Grady

When a division of John Romines Estate  
was about taking place between Grady the  
Compt. & John Romines Heirs. The Depts  
Col. Do. Lane was the friend of John Romines Heirs and  
offered to establish the corner, ~~between the lines~~ according  
to the papers, wherever the lines from Black A  
& Black C should intersect - but Grady refused  
saying he would have the corner at the ~~small~~  
stone black B - to which Romines Heirs objected.  
& further this Respondent answers not  
not admitting any part of the Compt. Bill.  
& praying to be hence dismissed with his costs in  
this behalf wrongfully expended. William Francis

The answer of Isaac M. High & Jeremiah M. High to  
a Bill in Chancery exhibited against Rebecca Romine  
Widow. & Depts by James Grady

This Respondent saying and reserving to him self all  
and every benefit of exception to the many uncertainties  
intrusions and imperfections in the Compt. Bill contained in  
answer thereto says: that they know nothing about  
the circumstances mentioned in the Compt. Bill.  
That they heard a conversation between  
the Compt. Grady & Rebecca the Widow Depts  
in this cause, wherein she stated that William  
Dillon had made a survey of the line from  
black A on the plat in this cause - & stopped at  
B a place where a stone was put in a thicket of  
saplings, & a mark made as night came  
on, that the corner might be found by the  
intersection of the lines from black A &  
black C. and she proposed that the place where  
the said lines  
the ~~lines~~ intersected should be the corner  
between them - she also stated that the stone  
was placed at black B because they wished  
easily to find the place where Dillon from  
the approach of night was obliged to end his survey.  
That the point of intersection might be known  
on the lines C B & A B. Grady denied no part of the  
statement - They pray to be hence Isaac Romine  
dismissed with their costs in this behalf James Grady  
wrongfully expended

I do hereby certify that the within answers, were sworn  
to before me by the several subscribers thereto -  
this 1<sup>st</sup> day of May 1812 - Given under my  
hand & seal &c

W. Williams 

Nomine &  
ads. } answers &  
Grady

The Department of -

The Bill in this cause being taken per Coupled and set  
per decree and coming in now to be heard upon the  
Bill and depositions taken by the Coupl. The Court  
upon considering the same are of opinion that  
the dividing line between the Complainant and  
defendants is truly describ'd upon the plat returned  
in this cause by the black line and letters A. B.  
and the Court doth adjudge and establish the said  
black line as the dividing line between the Complainant  
and defendant and doth decree and order that the  
Complainant recover of the said defendant the

Lead up to the said black line - It is further decreed  
and ordered the Testimony filed in this cause be  
made perpetual - and it is further decreed that  
the defendant pay to the complainant his costs by  
him about his suit in this behalf expended -

Wm  
H. Jones

London, Oct. 17. 1781

enclosed Depos

ing as to deliver to the Clerk Mr  
Sims, after examining them to make  
an report, I Confide in you to take care  
and deliver them safe to Mr. Sims and  
W. Mo. 060 St.

Ben: Giamon

January 20<sup>th</sup> 1803

Grady  
vs  
Depus  
Received March  
the 1st 1803

Wm John Mather

The Deposition of Elsha Marks of full age, taken on a Survey  
wherein James Grady is Compt. against Rebecca Romine ~~Widdow~~  
and Heir of John Romine De<sup>d</sup> and other De<sup>s</sup> pending before the  
Worshippful Court of London In Chancery, in the presence of the  
Parties who acknowledged legal Subpoenas to have been given to this  
day viz: the 19<sup>th</sup> day of January 1803 at the House of the S. James Grady  
Deponent and saith that John Romine De<sup>d</sup> about ~~sixteen~~ ~~or~~ ~~seventeen~~  
~~seventeen~~ years ago shew'd him one or more stones on a ridge  
as a corner to his Land, and as well as his memory now serves him  
he thinks there was two or three tones - Question by the De<sup>s</sup> Is  
the Stone shew'd to day, in the place and the same that John  
Romine shew'd you, answer I do not know that it is the same  
Stone or in the same place, but I believe it to be some where there  
about, Question Did you find to day at the afores<sup>d</sup> Corner more  
Stones than one, answer no - Did not that stone appear to you to be  
small and easily moved, answer, Yes it is light and easily moved  
& appears not to have been planted in the ground - Question by  
the Pl<sup>ff</sup> Did you see any small Stones to day near S<sup>d</sup> Corner, ans<sup>r</sup>?  
Yes I saw a small Stone about six or 8 feet from the Stone said  
to be the corner & appeared to be to him to be about the size of some  
that he had seen there before - Question, by the De<sup>s</sup> During the  
life time of John Romine did you know any thing of any inter-  
-mediate marked tree emanating from the white Oak to the  
above mentioned Stone, answer I know nothing of any line tree  
except a Gum shew'd to me by I know not who - Is there not  
a marked line from the white Oak where the Surveyor ended this  
Evening to the white Oak where he started on this

Course Running South  $85^{\circ} 20'$  E. answer I have followed  
an ancient marked line of trees, from the white oak where  
the Surveyor ended this evening to the edge of the Hill near  
the Creek, which is about twenty five Poles from the <sup>oak</sup> white  
and further this Deposition south not

London Et.

Elisha Markes

Sworn & subscribed before  
me this 19<sup>th</sup> day of Jan<sup>y</sup> 1803

Ben: Grayson

Deposition  
Elisha Markes  
Grady } In  
vs } Chancery  
Romine &c }



The Deposition of Lydia Reed about twenty two years of  
Age, taken on a Survey wherein James Grady is Compt.  
of Rebecca Nomine Widow and Relict of John Nomine  
Deft? and others Defts In about In Chancery now Pending  
before the Worshipful Court of London - In the presence of  
the Parties who acknowledged legal Subpoenas to have been  
given to this day viz<sup>t</sup> the 19<sup>th</sup> day of January 1803 - At the House  
of James Grady the Compt. Deposes and says that some time  
ago but when she does not remember, she heard Rebecca  
Nomine tell James Grady that she was willing to swear  
to the best of her knowledge that where <sup>she</sup> stood was her corner;  
that she heard him further say, that she helped ~~Rebecca~~ to  
carry the Chain when Dillon Surveyed the Land - The  
Deft<sup>s</sup> having and reserving to themselves now and at all times  
hereafter all manner of ~~advantages~~ and benefit of excep-  
-tion to the competency of this Deponent &c - and further  
this Deponent saith not - -

London Sc<sup>t</sup>

Lydia <sup>her</sup> Reed  
marks.

This Deposition subscribed and  
Sworn to January 19<sup>th</sup> 1803 before me }

Ben: Grayson

Despatch  
Lydia Reed  
Gladly } In  
at } Chanery  
Romene &c.

The Deposition Jonathan Waters of full age, Taken  
on a Survey wherein James Grady is Comp<sup>t</sup> as<sup>t</sup> Rebekah  
Romine Widow and Heir of John Romine dec<sup>d</sup> and others  
Defts In a suit in Chancery now depending before the Wor<sup>sh</sup>  
= shipful Court of London - In the presence of the Parties who  
acknowledged legal Subpoenas to have been given to this de<sup>po</sup>  
= sition the 19<sup>th</sup> day of January 1803 - at the House of James  
Grady the Comp<sup>t</sup> - Deposes and says, that about three  
years ago, he was present when the s<sup>r</sup> Rebekah Romine  
shewed the Comp<sup>t</sup> a stone by a Gum bush, as a corner  
to her late Husbands Land, and observed that she as  
= sisted in carrying the chain when the Land was  
Surveyed, and being fatigued, set down while they made  
the corner, and this Deponent well remembers that the Comp<sup>t</sup>  
asked her if she was willing to swear, that, that, was the  
Corner, She replied, that she would swear to the best  
of her knowledge it was the Corner between the two  
Plantations - The Deft<sup>s</sup> saving and reserving to them  
= selves now and all times hereafter all manner of  
advantage and benefit of exceptions to the competency  
of this Deponent &c. - Question by the Deft<sup>s</sup> did you mar  
= ry one of the Compt<sup>s</sup> Daughters, answer, yes - Upon what  
occasion did you assemble when Rebekah Romine shewed  
the Comp<sup>t</sup> a stone by a Gum bush, as a corner to her late  
Husbands Land - answer, I was called upon, <sup>as a witness</sup> as I understood  
it, to have the Corner established, by whom were you called  
upon as a Witness, answer, By the Comp<sup>t</sup> - You say she  
Rebekah assisted in carrying the chain, who made the Survey,  
answer John Scatterday - Did he by running the Land, by  
John Romine's courses go to the Stone <sup>shewed</sup> to day, in his first  
attempt, answer, No, He fell a little to the right of the Stone  
Corner - who made the Corner while the s<sup>r</sup> Rebekah was resting her  
= self, who do you mean by saying "they made the Corner, answer  
I understood her that John Romine and the Surveyor made it -  
Further this Deponent saith not -  
London s<sup>t</sup> Jonathan <sup>his</sup> Waters  
marks

This Deposition Subscribed and  
Sworn to January 19<sup>th</sup> 1803 before me

Ben: Grayson

Deposition  
Jonathan Waters  
Grady } In  
at } Chancery  
Romney

The Deposition of Jonathan Drake aged about 59 years  
taken on a Survey wherein James Grady is Comp<sup>t</sup> ag<sup>t</sup> -  
Rebekah Romine widow and relict of John Romine dec<sup>d</sup>. and  
others Def<sup>s</sup> Pending before the Worshipp<sup>l</sup> Court of London in  
Chancery The parties acknowledged legal Subpoenas  
to have been given to this day viz<sup>t</sup> the 19<sup>th</sup> day of January 1803  
at the House of s<sup>r</sup> James Grady - Depos<sup>r</sup> and says that about  
Ten years ago, John Romine of an<sup>r</sup> shewed him a Gum tree  
marked as<sup>t</sup> line, and forbid him to cut timber beyond it  
which he said was his line, and further this Depo<sup>n</sup>t  
saith not - Question by the Def<sup>s</sup> reserving to themselves  
benefit of  
all exceptions &c. against the Competency of the Depo<sup>n</sup>t  
Do you know any thing about the <sup>Gum &</sup> Stone corner, shewn  
the Surveyor to day and claimed by the Comp<sup>t</sup>, answer  
I never saw it before to day - Did John Romine when  
he forbid you cutting timber over a certain line and point  
ed out the Gum tree to you, mention any thing to you  
about a small Gum and Stone at the end of that line, answer  
no he did not, Question by the Comp<sup>t</sup> Did not John Romine  
tell you, that his fence was on my Land, answer<sup>r</sup> Yes he did ~~and~~  
and shewed me the fence when it was over the line, Question  
by the Def<sup>s</sup> Did John Romine ever shew you the begin<sup>n</sup>  
-ning or ending of that Line, answer, no he did not -  
London J<sup>r</sup>

Jonathan <sup>his</sup> Drake  
mark

This Deposition Subscribed and  
sworn to January 19<sup>th</sup> 1803 before me

Ben<sup>o</sup> Grayson

Disposition  
Jonathan Drake  
Grady  
or  
Nominat<sup>ed</sup> } In  
Chancery

AB, C, and black lines show's the Complainants Survey of two lines of John Romines Deed dated 22<sup>nd</sup> Aug<sup>r</sup> 1783.  
 C, B, and red line show's a line of Peter Romines deed dated 25<sup>th</sup> Dec<sup>r</sup> 1787 run by direction of Defend<sup>t</sup>  
 C, B, and red line thus show's a line protracted by Def<sup>t</sup> direction for a line of John Romines Deed with a variation of one degree.  
 A, a white Oak anciently marked as a corner shown by the Compt<sup>t</sup> as an Original Corner of John Hanby's Patent also a corner of John Romine, Lewen Powell, and the Complainant,  
 B, a Stone by a small Gum referred to in the deposition of Lydia Reed, Jonathan Waters, & Elisha Marks, this stone is not large nor fixed in the Ground but can be moved with ease,  
 C, a white Oak run from as a Corner by both parties  
 B, The intersection of the red line from C, with the Patent line,  
 B, in the Patent line, no corner, near a stake lately put in the Ground,  
 W.O., a white Oak marked as a corner on the proper sides for a corner to John & Peter Romines Lots 4 poles from B, contended by the Defend<sup>t</sup> to have originally been made a corner to John Romine, Peter Romine says that this Tree was marked by Stephen Koppel dec<sup>d</sup> when he was laying off the Lots but the said Koppel would not return the plat and another Surveyor was employed, The red dotted line with red images thereon representing trees, show's 4 line Trees whose bearing is S 81<sup>1</sup>/<sub>2</sub> E laid down by the Defend<sup>t</sup>.

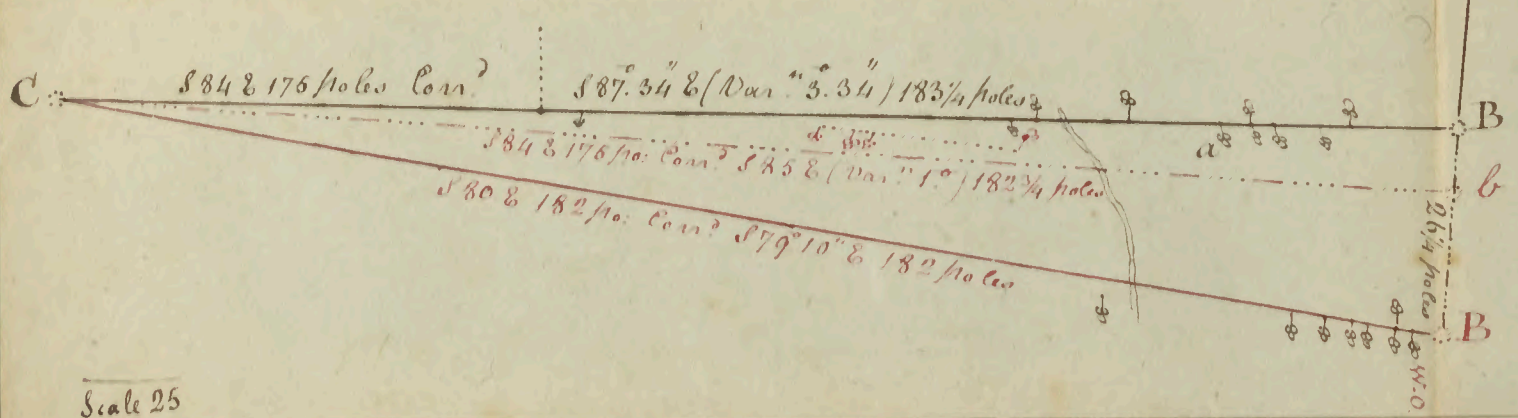

A  
 510 W. Cor<sup>d</sup> S 55° 24' W (Var<sup>n</sup> 4° 36') 181 1/2 poles  
 B  
 C  
 D  
 E  
 F  
 G  
 H  
 I  
 J  
 K  
 L  
 M  
 N  
 O  
 P  
 Q  
 R  
 S  
 T  
 U  
 V  
 W  
 X  
 Y  
 Z  
 W.O.

to run with a Variation of 4° 36' for John Hanby's Patent S 55° 24' W 181 1/2 poles to B, having passed several ancient marked line Trees. Co<sup>l</sup> Lane who acted for the Defend<sup>t</sup> being now present directed me to extend the line from B, to B, by 26 1/4 poles making the line from A, to B, in all 207 3/4 poles, I was then directed to C, thence to run a line for John Romines Deed on a course S 85 1/3 E put falling to the South of the Stone 7 poles, I was directed to connect the line to the Stone w<sup>th</sup> Black line, Adjourned to the 27<sup>th</sup>

27<sup>th</sup> present James Grady, Peter Romine, Co<sup>l</sup> J. Lane & others, I was directed to begin at C, thence S 87° 34' E (at 63 1/2 poles crossed dotted line and left a field, the corner of the fence Jonathan Drake says John Romine told him was on James Grady's land (I am not certain that this is the place alluded to in the deposition of Drake as the line passed thro' the corner of another field on John Romines Lot) at 68 1/2 poles passed to the North of a fore & aft Tree half a pole, at 124 3/4 poles passed to the left of a fore & aft tree about 18 inches, at 128 poles passed to the right of a fore and aft tree about one foot, at 140 poles passed a side line on the side marked, at 152 poles 15 links passed about 9 links to the North of a Gum referred to in the deposition of Elisha Marks & Jonathan Drake, this Tree stands by a road and is marked on the side, I left it with 6 chops & a blaze of different ages and in different positions, at 155 3/4 poles passed about 9 links to the North of two line trees marked for a line to pass between, at 158 3/4 poles passed about 5 links to the North of a side line marked on the South side, at 164 1/2 poles passed about 6 links to the North of a fore & aft Tree, & at 169 poles passed a side line on the side marked) 183 1/4 poles to B,

I was then directed by Co<sup>l</sup> Lane for the Defend<sup>t</sup> to begin at C, thence to run w<sup>th</sup> Red line to B, at 104 poles I was directed to run N 12 3/4 W 13 poles to a side line Tree, thence to run with the line Trees as laid down on the line thus.....

28<sup>th</sup> I was then directed to begin at the end of 104 poles and extend the line to B, at 139 poles passed one pole & 21 links to the North of a line tree, at 142 poles crossed branch, at 164 poles passed 16 links to the North of a side line, at 168 3/4 poles passed 10 links to the North of a fore & aft Tree, at 171 3/4 poles passed to the North of a side line, at 173 3/4 poles passed to the North of a side line both about the same distance as the last fore & aft Tree, passed two other side lines, and at 178 poles the White Oak W.O.

I was then directed to run from C, S 85° 37' E 126 poles not laid down on plat  
 In<sup>o</sup> Matthias S. L. C.  
 Josiah Romine, Ed<sup>d</sup> Grady } S.C.C.  
 Jerry M<sup>o</sup> Query & Jesse Romine }

Loudoun County Se<sup>t</sup>  
 James Grady ag<sup>t</sup> Compt<sup>t</sup>  
 Rebecca Romine Widow of John Romine dec<sup>d</sup>  
 Susannah, Ann, Elizabeth, John, Rachel, & Josiah Romine Children of John Romine dec<sup>d</sup> Will<sup>m</sup>  
 Francis & Mary his Wife & M<sup>o</sup> Deigh & his Wife } Def<sup>t</sup>  
 In Chancery  
 In Obedience to an order of the Worshipfull Court of Loudoun County dated the day of 1802 at the instance of the Compt<sup>t</sup> & attended on the Land in Controversy on the 19<sup>th</sup> Jan<sup>y</sup> 1803 present the Compt<sup>t</sup>, Peter Romine & others, I was directed by the Compt<sup>t</sup> to begin at A, thence

Genl Grady } Plat  
Capt }  
Reb<sup>l</sup> Romine }  
& others }



A, B, C, and black lines show's the Complainant's Survey of two lines of John Romine's Deed dated 22<sup>nd</sup> Aug. 1783.  
 C, B, and red line show's a line of Peter Romine's Deed dated 25<sup>th</sup> Dec. 1787 run by direction of Defend.  
 C, B, and red line thus show's a line protracted by Defend.<sup>s</sup> direction for a line of John Romine's Deed with a Variation of one degree  
 A, a white Oak anciently marked as a corner shown by the Compt. as an Original Corner of John Hanby's Patent also a corner of John Romine, Seven Nowel, and the Complainant,  
 B, a Stone by a small Gum, referred to in the deposition of Lydia Reed, Jonathan Waters, & Elisha Marks, This Stone is not large nor fixed in the ground but can be moved with ease.  
 C, a white Oak run from as a corner by both parties  
 B, the intersection of the red line from C, with the patent line,  
 C, in the Patent line, no corner, near a stake lately put in the ground,  
 W.O, a white Oak marked as a corner on the proper sides for a corner to John & Peter Romine's Lots 4 poles from B, contended by the Defendants to have originally been made a corner to John Romine... Peter Romine says that this Tree was marked by Steph. Koppel dec. when he was laying off the Lots but the said Koppel would not return the Plans and another Surveyor was employed.  
 The red dotted line with images thereon representing Trees, show's 4 line Trees whose bearing is S 81 1/2 E laid down by the Defendants

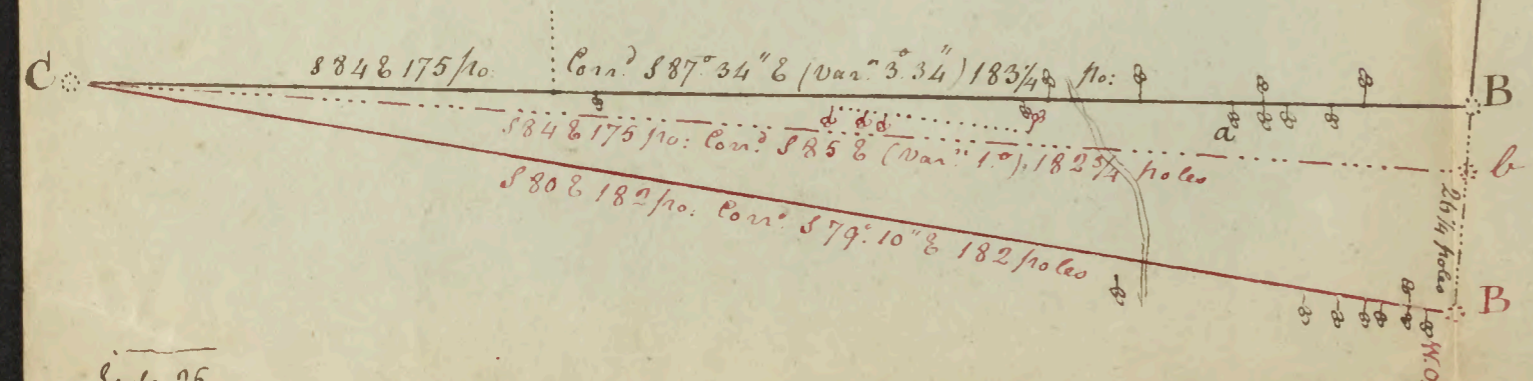
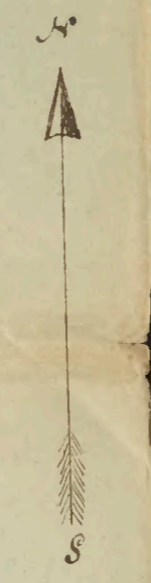

Scale 25

Loudoun County Sc.  
 James Grady ag<sup>t</sup> Compt.  
 Rebecca Romine Widow of John Romine dec.  
 Susanah, Ann, Eloya beth, John, Rachel & Isaac } Def<sup>s</sup>  
 Romine Children of John Romine dec. Will.<sup>m</sup>  
 Frances & Mary his wife } W. Veigh &  
 his wife

In Chancery

In Obedience to an order of the Worshipfull Court of Loudoun County dated the day of 1802 at the instance of the Compt. I attended on the Land in controversy on the 19<sup>th</sup> Jan. 1803 Present the Compt. Peter Romine & others, I was directed by the Compt. to begin at A, thence to run (with a

Variation of 4.36 for John Hanby's Patent) S 5° 24' W 181 1/2 poles to B, having passed several Ancient marked line Trees... Co. J. Lane who acted for the Defend.<sup>s</sup> being now present directed me to extend the line from B to B, W. 26 1/4 poles making the line from A to B, in all 207 1/4 poles, I was then directed to C, thence to run a line for John Romine's Deed on a course S 85 1/2 E put falling to the South of the Stone 7 poles, I was directed to correct the line to the Stone as a Black line, adjoined to the 27.  
 27<sup>th</sup> Present James Grady, Peter Romine Co. J. Lane and others, I was directed to begin at C, thence S 87. 34" E / at 63 1/2 poles crossed dotted line and left a field, the corner of the Fence Jonathan Drake says John Romine told him was on James Grady's Land (I am not certain that this is the place alluded to in the deposition of Drake as the line passed thro' the corner of another field on John Romine's Lot) at 68 1/2 poles passed to the North of a fore and aft Tree half a pole, at 124 3/4 poles passed to the left of a fore and aft Tree about 18 Inches, at 128 poles passed to the right of a fore and aft Tree about one foot, at 140 poles passed a side line on the side marked, at 152 poles 15 links passed about 9 links to the North of, a, the Gum referred to in the deposition of Elisha Marks & Jonathan Drake, this Tree stands by a road and is marked on the side I approached it with two chops and a Blaye on the side I left it with 6 chops & a Blaye of different ages and in different positions, at 155 1/4 poles passed about 9 links to the North of two line Trees marked for a line to pass between, at 158 3/4 poles passed about 5 links to the North of a side line marked on the South side at 164 1/2 poles passed about 6 links to the North of a fore & aft Tree, at 169 po. passed a side line on the side marked) 183 1/4 poles to B,  
 I was then directed by Co. Lane for the Defend.<sup>s</sup> to begin at C, thence to run as a Red line to B, at 104 poles I was directed to run S 12 1/2 W 13 poles to a side line Tree, thence to run with the

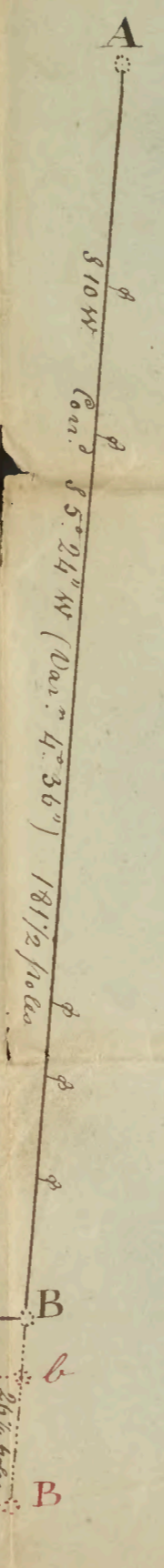

line Trees as laid down on the line thus.....  
 28<sup>th</sup> I was then directed to begin at the end of 104 poles and extend the line to B, at 139 po. passed 1 pole and 2 links to the North of a side line Tree, at 142 po. crossed branch at 164 po. passed 16 links to the North of a side line, at 168 3/4 po. passed 10 links to the North of a fore and aft Tree, at 171 1/4 po. passed to the North of a side line, at 173 3/4 po. passed to the North of a side line both about the same distance as the last fore & aft Tree, passed two other side lines, and at 178 poles the white Oak W.O.

I was then directed to run from C, S 85. 37" E 126 poles not laid down on plat.  
 Isaiah Romine, Ed. Grady, S.C. & Sery M. Query & Sepe Romine }  
 In. Matthias S.L.C.

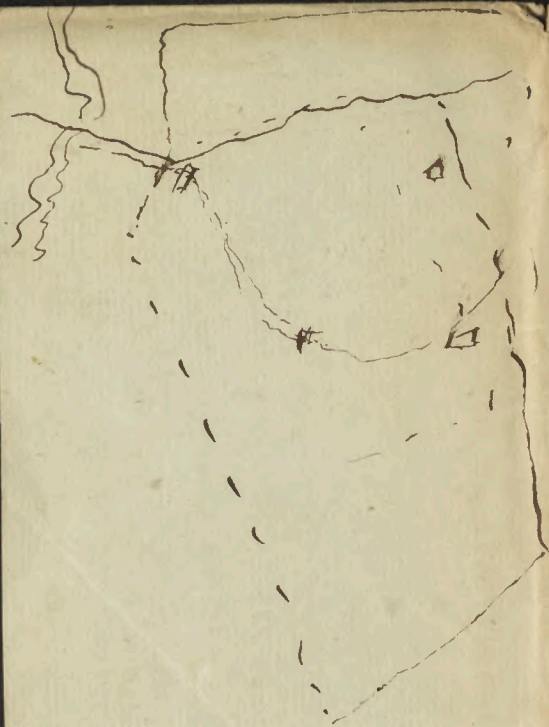

La. Grady } Plat  
          }  
Reb. Romine }  
          }  
          } Others ..



Reberath Remond Actm

Barich

Elisabetha 2. undor age  
Abiquat Rogner

W<sup>m</sup> Francis Yonary his wife

Terimach Wierich & Sarah his wife

~~Wm Francis Yonary~~

The Commonwealth of Virginia, to the Sheriff of Loudoun county, Greeting:

WE command you to summon

*Bebechah Romney, widow, relict of James Romney, dec'd, and her children of John Romney, dec'd, in the County of Loudoun*

To appear before the Justices of our said County Court in Chancery, at the Court-

house thereof, on the Second Monday in *November* next, then and

there to answer a Bill in Chancery exhibited against *them* by *James*

*Grady*

and this *Bill* shall in no wise omit under the penalty of *£100*, and have then there this writ. Witness Charles

Binns, Clerk of our said Court, the *21<sup>st</sup>* day of *August* 1782

and in the *27<sup>th</sup>* year of the Commonwealth,

*Binns*

and O. S. H. Bout  
Dea Motu Compt.  
Wm Francis &  
Mary his wife  
J. McVeigh & W.  
made depts  
to his Bill  
& Count.  
1803 Jan'y  
went for Bill  
to establish the  
Felicity depts  
of the  
County  
to one of  
the Compt. and  
in before depts  
depts de.

14  
Gaddey  
Romine  
Bang

To November 1802  
to establish the  
County between  
the Compt. and  
depts de.  
Swamp  
1802 Nov 10<sup>th</sup>  
depts de to take the  
depts of Eliza Marks  
son a Crane son a  
Water Lydia Reed

Copy left for Rebeah  
Romine Wood Reick  
of John Romine ch. Susan  
-na Ann Elizabeth John  
and Edwigh Romins

Copy left for Jeremiah & Eliza  
Sarah his wife executed  
on William Foxan ce and  
Mary his wife on the  
15<sup>th</sup> October 1802  
Saml. B. eggs Dr  
Dr. Sam. Noble